

# MIDWEST MANIA<sup>®</sup>

OCT. 5-7, 2018

**OUTLINES, EVALS & CECS**  
[www.scwfit.com/MW18](http://www.scwfit.com/MW18)

**KEY**

- ELEVATOR
- ESCALATOR
- RESTROOMS
- FOOD

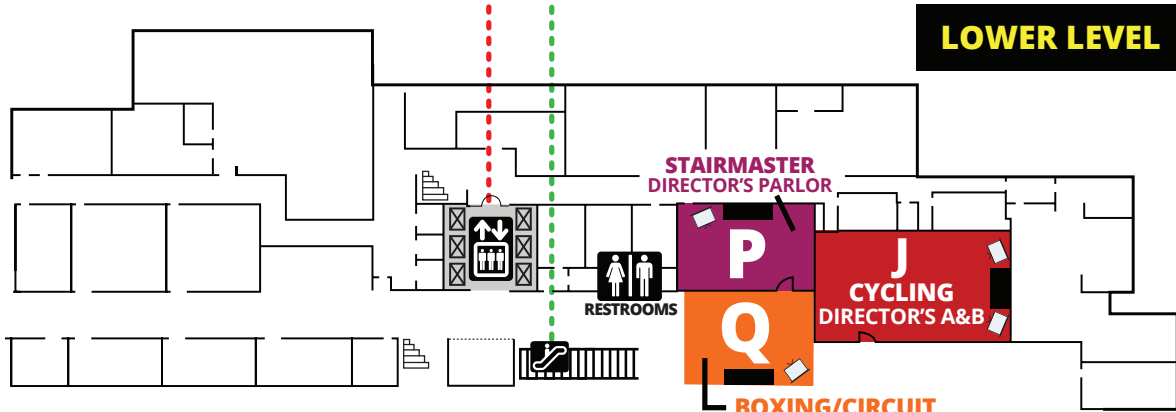
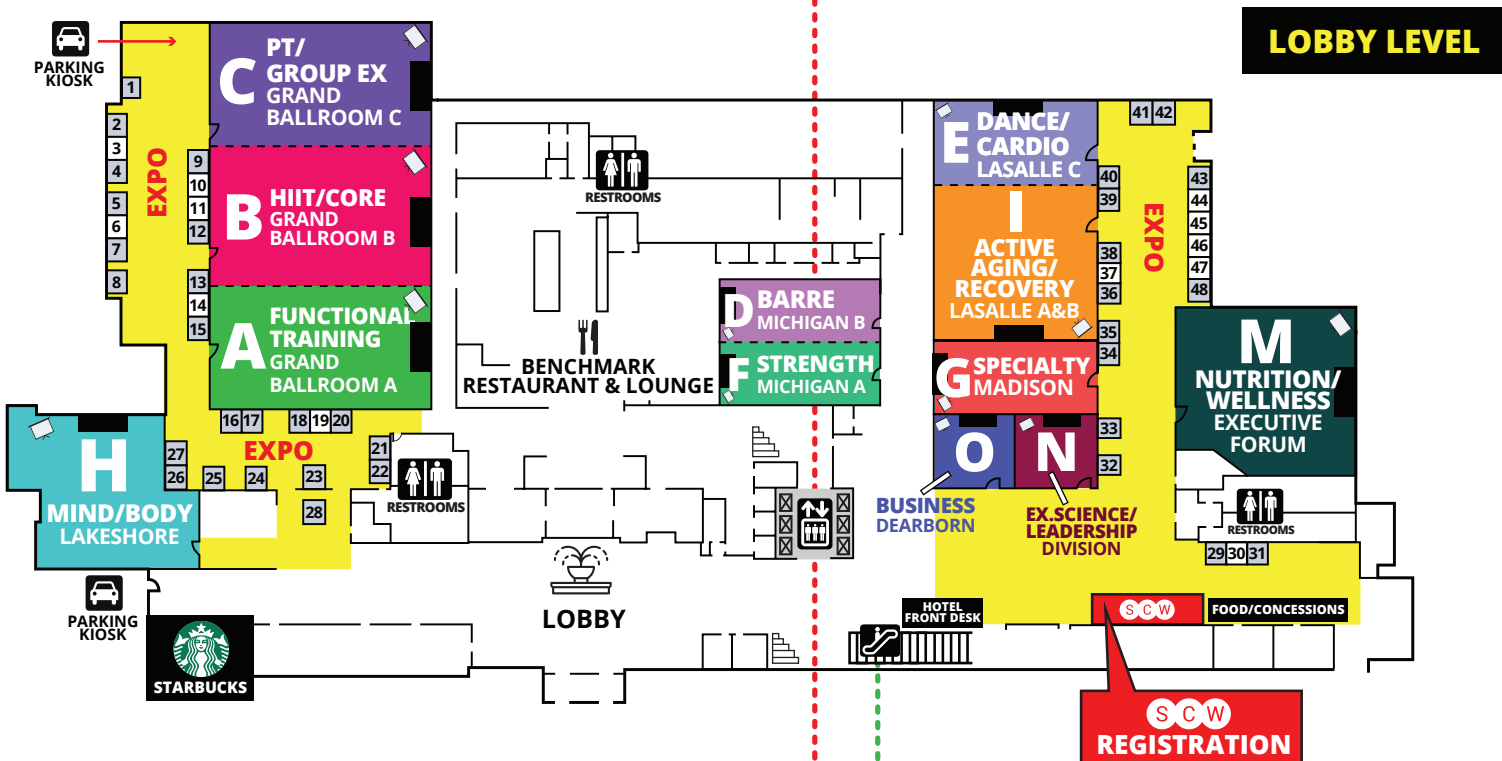
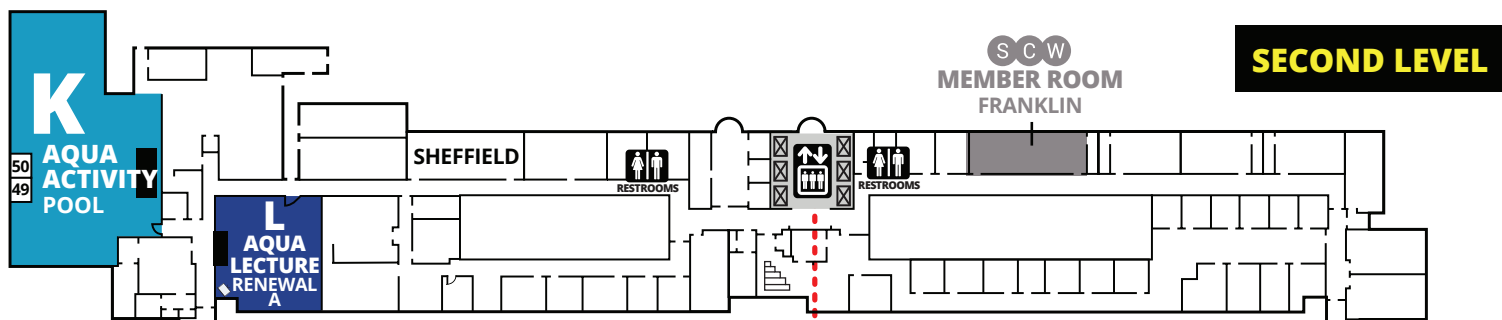

# MIDWEST MANIA®

## EXPO & SPONSORS

### EXPO HOURS

**FRIDAY, OCT. 5** 8:45 AM – 2:30 PM  
5:15 PM – 6:45 PM

**SATURDAY, OCT. 6** 8:15 AM – 9:30 AM  
12:15 PM – 3:30 PM  
6:15 PM – 7:45 PM

**SUNDAY, OCT. 7** 10:00AM -1:30PM

3ACT Slide.....15	Hyperice.....47	Savvier Fitness.....11, 12
3X3FIT.....25	Infinite Beauty.....36, 37	Schwinn.....22
ActivMotion Bar.....9	Maristella.....8	SCWFitness.....18, 19, 20
Athletic Apparel.....23	Namirsa.....28, 45	SCWExpress.....49, 50
Balanced Body.....4	One Day to Wellness.....10	Soul Clap.....44
Beachbody.....6	POUND.....41	Tepuy Activewear.....29
BOSU.....33	Power Music.....5	The BFF.....21
CA University of PA.....3	Power Systems.....16, 17	TriggerPoint.....39, 40
Chiro One.....46	RED Warrior.....48	Two Diamond Fit.....2
Club Pilates.....7	RIPPED.....35	Vumawear.....13, 14
ClubVibe.....34	Rollga.....38	WaterRower.....24
Hedstrom.....32	RumbleRoller.....43	Yes! Fitness Music.....30
HIGH Fitness.....31	Ryka.....26, 27	Zumba.....42

### PREMIER SPONSORS



### CO-SPONSORS



### ASSOCIATE SPONSORS



### PARKING INFORMATION

MANIA® attendees will receive a special parking rate from the hotel of \$10 per night (regularly \$25). Valet parking is \$35 per night.



**OUTLINES,  
EVALS &  
CECS**

[www.scwfit.com/MW18](http://www.scwfit.com/MW18)